

INSTALLATION INSTRUCTIONS FOR DUAL LEVER PUSH-PULL CONTROLS

In order to provide a satisfactory push-pull control system, the following points must be observed:

1. Control head must be installed on a flat and clean surface to avoid binding in the bearing sections.
2. When attaching the cable to the control head or the engine, it is important not to twist the inner core of the control cable, as this will cause additional friction.
3. The cables must be routed in a manner to have as few bends as possible and also to avoid sharp bends.
4. Ensure that all fasteners are tightened. For installations subject to severe vibration, secure screws with Loctite™ or similar.
5. Lubricate bearings and other moving parts with all-purpose grease occasionally.

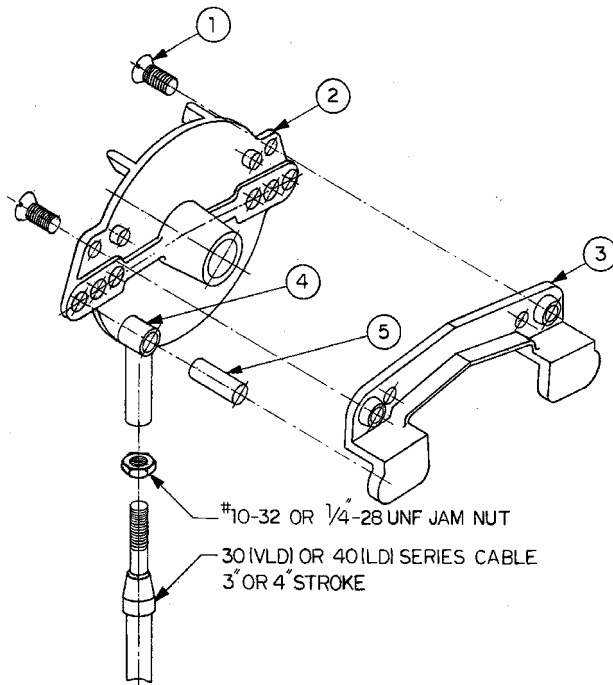

- Install push-pull cable in cable connector (item 4) together with a jam nut.
- Loosen flat head screw (item 1) to separate pin retainer (item 3) from pivot plate (item 2). Screws (item 1) are provided with sufficient length to allow for pin insertion without total screw removal.
- Insert pin (item 5) into cable connector (item 4). Apply a small amount of grease to pin.
- Now install cable connector between pivot plate and pin retainer, and tighten screws securely.

Note: The pivot plate is equipped with several attaching points for the cable connector to provide appropriate stroke.

